

COMMITTEE OF ADJUSTMENT

DECISION OF COMMITTEE WITH REASONS  
RE APPLICATION FOR MINOR VARIANCE

Planning Act, R.S.O. 1990, c. P.13, ss. 45(8)

APPROVAL AUTHORITY: THE CORPORATION OF THE TOWN OF ORANGEVILLE

RE AN APPLICATION BY: Laura and Antonio La Rocca

LOCATION OF PROPERTY: Part of Lot 22, Block 7, Plan 138  
2 Peavoy Lane

PURPOSE OF APPLICATION: The applicant is seeking permission to enlarge a legal non-conforming use in order to build a private residential garage with a second storey space that will be attached to the existing single detached dwelling.

WE, the undersigned, in making the decision upon this application have considered whether or not the variance requested was minor and desirable for the appropriate development and use of the land and that the general intent and purpose of the zoning by-law and the official plan will be maintained, or in the case of a change in a use of property which is lawfully non-conforming under the by-law as to whether or not this application has met the requirements of section 45 (2) of the Planning Act,

CONCUR in the following decisions and reasons for decisions made on the 15th day of May, 1996.

DECISION: Granted

CONDITIONS - This decision has been made subject to the following conditions:  
None

REASONS FOR DECISION: Expansion of the legal non-conforming use is considered desirable and appropriate on the subject property.

 Signature of Member

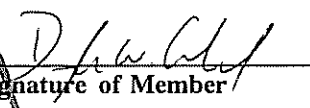
 Signature of Member

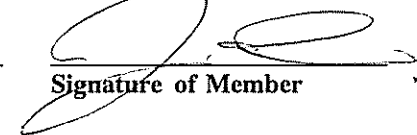
 Signature of Member

\_\_\_\_\_  
Signature of Member

\_\_\_\_\_  
Signature of Member

CERTIFICATION

Planning Act, 1990, R.S.O. c. P.13, ss. 45(10)

I, Marion Morris, Secretary-Treasurer of the Committee of Adjustment certify that the above is a true copy of the decision of the committee with respect to the application recorded therein.

DATED THIS 22nd day of May 1996.

  
\_\_\_\_\_  
Marion Morris, A.M.C.T.(A)  
Secretary-Treasurer

<b>CAUTION:</b> THIS PLAN IS NOT A PLAN OF SUBDIVISION WITHIN THE MEANING OF THE PLANNING ACT.	I REQUIRE THIS PLAN TO BE DEPOSITED UNDER THE REGISTRY ACT.	<b>PLAN 7R-</b>
	(DATE) _____ D.J. CULLEN Ontario Land Surveyor	RECEIVED AND DEPOSITED (DATE) _____ A. T. Woodland Land Registrar for the Registry Division of Dufferin (11271)

PART SCHEDULE				
PART	LOT	LOCATION	INST. N <sup>o</sup>	AREA
1	Part of LOT 22	Block 7 Registered Plan N <sup>o</sup> 138 (Town of ORANGEVILLE)	MF 58717	0.008 Ac

**NOTE:**  
 INST DENOTES INST. N<sup>o</sup> MF 58717  
 PI DENOTES REGISTERED PLAN N<sup>o</sup> 138  
 LT DENOTES PLAN OF SURVEY BY I. THOMSON O.L.S., DATED JULY 27, 1965

**PLAN OF SURVEY OF  
 PART OF LOT 22  
 BLOCK 7  
 REGISTERED PLAN N<sup>o</sup> 138**

**TOWN OF ORANGEVILLE  
 COUNTY OF DUFFERIN  
 SCALE - 1 INCH = 20 FEET**

1980  
 D. J. CULLEN, O.L.S.  
SURVEYOR'S CERTIFICATE

I CERTIFY THAT

- THIS SURVEY AND PLAN ARE CORRECT AND IN ACCORDANCE WITH THE SURVEY ACT AND THE REGISTRY ACT AND THE REGULATIONS MADE THEREUNDER
- THE SURVEY WAS COMPLETED ON THE 11th DAY OF NOVEMBER, 1980

NOVEMBER 12, 1980 *D.J. Cullen*  
 DATE D.J. CULLEN  
 ONTARIO LAND SURVEYOR

ALL HANGING LINES SHOWN ON THIS PLAN HAVE BEEN VERIFIED BY TWO INDEPENDENT MEASUREMENTS.

BEARING REFERENCE

BEARINGS ARE ASTRONOMIC, DERIVED FROM THE NORTH EAST LIMIT OF MAIN STREET SHOWN AS S45°22'W ON A PLAN OF SUBDIVISION RECORDED HEREIN IN THE LAND REGISTRY OFFICE FOR THE REGISTRY DIVISION OF DUFFERIN AS REGISTERED PLAN N<sup>o</sup> 138

- DENOTES STANDARD IRON BAR PLANTED (1"sq. X 48" or 25.4 mm<sup>2</sup> X 1219.2 mm)
- DENOTES IRON BAR PLANTED (5/8"sq X 24" or 15.9 mm<sup>2</sup> X 609.6 mm)

D.J. CULLEN LIMITED ONTARIO LAND SURVEYOR 59 THIRD STREET, ORANGEVILLE, ONTARIO L9W 2B3 TEL: 519-941-3881	
EXAMINED BY: A.J. MAES, C.E.T.-C.S.T. D.J. CULLEN, O.L.S.	PARTY CHIEF D.J. CULLEN, O.L.S.
CALC. BY: K. STILL C.S.T.	PROJECT N <sup>o</sup> 131-80

ED PLAN No 138

LOT 23  
LC-22

Wire Fence  
phys' and

Inst. 11<sup>o</sup> M.F. 61264

LOT 22

N45°27'W Inst. B Set  
51'27 Meas  
Board

Phys. B  
5'00 W.W.  
Fence

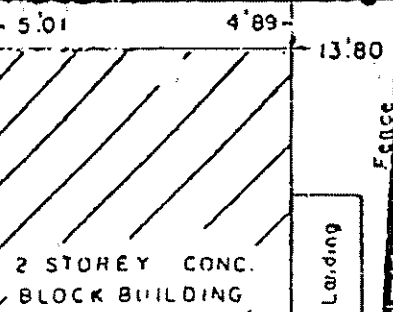

50'16 Pl.  
51'27 Prop. B Set

100'32 Pl. 102'54 Meas.

LOT 22  
N44°33'E  
61'71 LT

LOT 21  
N44°33'E 50'00 Inst. B Set

See Plan of Survey  
by L. THOMASCIOLS  
dated July 23, 1965.

114°27'W  
128'80 LT

LOT 21

N45°27'W  
2'31 LT

Inst. No  
M.F. 93488

Inst. No  
M.F. 61264

STREET

STREET

